

**SNUCMAA of NA** *32<sup>nd</sup>*  
**Annual Convention and Scientific Meeting  
Program and Abstracts**



**June 4 (Thur) ~ 7 (Sun), 2015**

**Glenpointe Marriott Hotel  
Teaneck, New Jersey**



**Presented by  
Seoul National University College of Medicine  
Alumni Association of North America**

**Sponsored by  
Jefferson Medical College of Thomas Jefferson University**

Message from the President	2
Message from the Convention chairs	3
Message from the Scientific chairs	4
General Program	5
CME Program description, Objectives, CME Programs & Faculty	6
“President Shin Ho Kang Lectureship”	
General Information	8
Registration	
Name Tags	
Breakfast/Lunch Guide	
Ground transportation	
From airport to hotel	
Parking	
Bus from hotel to Hoboken 14th St. Pier	
Ferry from West 39th St. Terminal in Manhattan to Hoboken 14th St. Pier	
Car rental / Airline Information / Local restaurants	
Meet the Authors	
About Glenpointe Marriott Hotel	10
Banquet & Conference Places	
Faculty List	11
Sigetop 40th Anniversary Ceremony	
“합춘공로상” Award Ceremony	
Photo Contest Award Ceremony	
Class Reunion	
Scientific Session	13
Non-CME Program	15
Green Project Forum	17
President Forum	18
June 5th, Session	21
June 6th, Session	38
Lists of Donors for the Convention	53

## Greetings from the President



청양의 해도 어느덧 반 남짓 지나갔습니다.

모든 임원들이 성심껏 준비를 해왔습니다. 좋은 결과를 기대해 봅니다.

한창규 총무와 오무연 GP chair, 이선희, 남영규 등 핵심 GP committee member들의 노력으로 15명의 GP member들이 CME speaker로 출선수범하여 나섰고, 유례없이 높은 젊은 동문들의 참가를 보여주고 있어서 새로운 기운의 대회가 펼쳐질 듯 합니다. 선배 동문들의 격려와 관심 속에서, 후배 동문들의 눈부신 활약으로써 앞으로 매년 더욱더 진보된 학술대회가 계속되리라 믿어 의심하지 않는 바입니다.

지난해 함춘의학상을 수상하신 강유구(71) 선배님께서 지난 4년동안 세번씩이나 학술위원장직을 맡아 봉사하셨는데, 강선배님의 헌신적인 노력이 없었다면 이토록 알찬 CME session들은 불가능했을 것입니다. 강신호 명예회장님께서 협찬해주신 “강신호 회장 Lectureship”의 첫 keynote speaker로서 강선배님의 특장이 있을 예정입니다.

매년 인기가 더 높아가는 non-CME의 다양한 주제들을 모아서 깔끔하게 배합시키신 Mrs. 김원정(75)과 Mrs. 한민우(75)께 감사의 박수를 보냅니다.

금요일 Banquet중 시계탑 40주년 기념행사가 있을 예정이오니, 장년의 나이를 맞은 시계탑이 동문들에게 마음의 고향되기를 바랍니다. 시계탑 편집장 주최 Photo Contest에 많은 동문들께서 훌륭한 작품들을 출품해 주셨습니다.

새로 시도해보는 국영순 여사(Mrs. 이명희 66)의 대합창, 김자성(85) 동문이 진행할 ‘Sing along’, 백승원(79) 동문의 MC 활약을 가슴설레며 기다립니다.

뉴욕에서 왕성한 작품활동을 하고 계신 미술 및 사진작가들의 작품들을 모아 Art Exhibit를 기획하신 안신영 화가(Mrs. John Baek)께 감사를 드립니다.

어느 동문 못지않게 손발 벗고 수고해주신 Jenny Chun 부부와 고 김은태(60) 부인이신 Mrs. Sue Kim께도 감사를 드립니다.

북미주 동문들만을 위한 ‘함춘공로상’을 마련해 주신 강대회(87) 학장님, 올 3월 취임 후 컷나들이로서 저희 미주 동문들을 찾아주시는 홍정용(75) 신입회장님, 오병희(77) 병원장님, 네분의 부학장님, 안효섭(71) 교수님, 문기찬(73) 교수님, 서유현(73) 원장님, 이강우(74) 원장님, 정준기(77) 교수님들의 따뜻한 성원에 진심으로 감사의 뜻을 표하는 바입니다.

Convention chair로 수고해주신 최준희(64) 선배님, Pre-convention golf outing을 위해 수고하시는 김상복(67) 선배님, 오용호(72) convention co-chair, post-convention tour 동안 wise stories (지담)를 맡아주시는 김은환(66) & 온기철(71) 선배님들의 노고를 어떻게 보답을 해드려야 할지 숙제로 남겨놓고 있습니다.

두 가지 확실한 과제와 숙제 (Harmony & Continuity)를 서윤석 차기 회장단께 넘겨드리며 내년을 기약해 봅니다.

모든 동문 여러분들과 가족들께 감사드립니다.

2015년 6월

서울대학교 의과대학 북미주 동창회 회장 서인석 올림.

## Message from the Convention Chair

2015년 학술대회에 참석하신 동문 및 가족 여러분:

이번 6월에 개최되는 32차 학술대회에 30여명의 젊은 후배 동문들이 참석할 예정입니다. 무려 60년의 연령 차이가 나는 신구세대가 함께 하는 모임이, 후배들을 배려하는 선배들의 따뜻한 손길과 사심없이 선배들을 존경하는 후배들간의 따뜻한 화합의 장이 되었으면 합니다.

앞으로는 Convention 등 모든 동창회 행사들을 후배 동문들이 적극적으로 주도하여 역동적인 방향으로 이끌어 나갈 수 있기를 바랍니다.

상당히 좋은 조건의 package 였는데도 Pre-convention golf outing 참석율이 예상외로 저조했습니다. Post-convention tour 동안 김은한 (66) 동문과 온기철 (71) 동문이 성심껏 준비해 오신 wise stories (지담)를 경청하시며 이천여년을 오가는 지혜를 담백 얻어가실 수 있을것입니다. 하루에 한 곳씩 winery를 방문하는 생생 실습을 끝내시고 나면, dinner table이 좀더 romantic 하게 변하실 것입니다.

멀리 모국에서 저희들을 성원해 주시려고 참석해주신 학장님, 동창회장님, 병원장님 등 모든 동문들께 감사를 드립니다.

전국 방방곡곡에서 모여드신 선 후배 동문님들, 마음껏 즐기십시오.

내년 버지니아에서 다시 뵙게 되기를 바라며, 온가정에 행복이 가득하시기를 비읍니다.

Convention Chair

최준희 (64), 오용호 (72) 올림.

# Message from the Scientific Committee Chair



Dear Alumni of SNUCM:

Welcome to the Scientific Session of the 32nd Annual Medical Convention of the SNUCMAA of North America. This scientific symposium carries a thematic title, “The Millennials” for two important reasons. Born in 1983, this convention has now matured as a millennial, reaching 32 years of age. In addition, this convention now enjoys a robust and enthusiastic participation of the younger generation, the true millennials. There are twelve speakers who graduated the SNUCM in the year 2000 or later, including a graduate of 2011. This was made only possible thanks to truly dedicated support of Dr. Sunhee Lee, and Dr. Mooyeon Oh-Park, who were instrumental in identifying and connecting with young alums for this convention.

The Scientific Session features truly diverse topics this year, ranging from neonatology to geriatrics, from anthropology to health care administration, from education to arts, and from medical law to cutting edge cancer therapy. Moreover, this year’s convention will witness the birth of the Dr. Kang Shinho lectureship. Established by a generous contribution of the President Emeritus, Kang Shinho, M.D., this lectureship will feature a special lecture annually.

It has been our pleasure and privilege to serve as Chairs of the Scientific Session, and it is our hope that the goals of this symposium are well aligned with our alums’ wishes to further develop in clinical, research and various other fields of medicine. We would also like to express our sincere appreciation and gratitude to all speakers, our energetic President (Dr. In Suk Seo), the Convention Chairs (Dr. John Choi and Dr. YoungHo Auh), and, the last but not the least, tireless and meticulous Jamie Kim. Please enjoy the Convention, as we surely will.

Sincerely,



Yoogoo Kang, M.D.(71)  
Chair, Scientific Committee

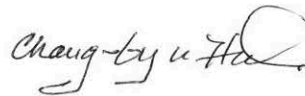

Chang-Gyu Hahn, M.D. (81)  
Co-Chair, Scientific Committee

# General Program

## June 4, 2015 (Thursday)

- 2:00 pm - 7:00 pm Registration
- 3:00 pm - "Korean-American Cancer Disparity" Committee Meeting
- 4:00 pm - 6:00 pm Delegate Meeting
- 5:00 pm - 7:00 pm Ice Breaking Reception
- 6:00 pm - 7:00 pm Speaker Ready Room
- 7:00 pm. - Class Reunion, meet friends & relatives

## June 5, 2015 (Friday)

- 7:00 am - 9:00 am Continental Breakfast and Registration
- 7:00 am - 7:40 am Speaker Ready Room
- 7:40 am -12:05 pm Scientific and Non Scientific Sessions I
- 12:05 pm - 1:05 pm Luncheon Meeting "Medical Economy Update"
- 1:05 pm - 4:30 pm Scientific and Non Scientific Sessions II
- 6:30 pm - 11:30 pm Banquet, Sigetop 40th Anniversary Ceremony

## June 6, 2015 (Saturday)

- 7:00 am - 9:00 am Continental Breakfast and Registration
- 7:00 am - 7:40 am Speaker Ready Room
- 7:45 am - 12:15 pm Scientific and Non Scientific Sessions III
- 12:15 pm - 4:00 pm Green Project Forum I
- 5:30 pm - Bus leaves hotel to Hoboken 14th St. Pier
- 6:30 pm - 11:00 pm Grand Banquet at the Cornucopia Majesty (Yacht)

## June 7, 2015 (Sunday)

- 8:00 am - 10:00 am President Forum with Continental Breakfast
- 8:00 am - 10:00 am Green Project Forum II with Continental Breakfast
- 8:00 am - 9:30 am Non Scientific Session IV
- 10:00 am Bus leaves hotel for Post-convention Tour

Post-Convention Tour: Canada에 머물 예정이니 유효한 PASSPORT를 반드시 지참하셔야 됩니다.

## **GENERAL INFORMATION**

The annual scientific symposium of the Seoul National University College of Medicine Alumni Association of North America (SNUCMAANA) has two specific objectives: a) To help members to be equipped with recent research and clinical information relevant to patient care, and b) to foster collaboration among members for research, clinical practice and contribution to the society. The symposium features oral presentations, poster exhibition and forum discussions. Presentations will feature diverse clinical specialties as well as clinical and basic science research.

The scientific symposium of the 32nd Convention of the SNUCMAANA is organized by Dr. Yoogoo Kang (71, Chair) and Dr. Chang-Gyu Hahn (81, Co-Chair) and supported by Dr. Sunhee Lee (81), Dr. Young-Jae Nam (94) and Dr. Mooyeon Oh-Park (89) of the Green Project Committee. The theme of the scientific symposium this year is "Millennials", which is in recognition of vigorous academic and clinical activities of young alumni, as reflected in participation of 15 speakers from the Green Project. Also included as speakers or participants are the Dean of SNUCM, President of the SNUCMAA, President of SNUH, 4 Associate Deans of SNUCM and other professors from Korea.

## **ACCREDITATION**

This activity has been planned and implemented in accordance with the Essential Areas and Policies of the Accreditation Council for Continuing Medical Education (ACCME) through the joint sponsorship of Jefferson Medical College and Seoul National University College of Medicine Alumni Association of North America.

Jefferson Medical College of Thomas Jefferson University is accredited by the ACCME to provide continuing medical education for physicians.

Jefferson Medical College designates this live activity for a maximum of 11.75 AMA PRA Category 1 Credit(s). Physicians should only claim credit commensurate with the extent of their participation in the activity.

## **DISCLOSURE OF SIGNIFICANT RELATIONSHIPS WITH RELEVANT COMMERCIAL COMPANIES & ORGANIZATIONS**

Jefferson Medical College endorses the Standards of the Accreditation Council for Continuing Medical Education and the Guidelines for Commercial Support. Every effort has been made to encourage faculty to disclose any commercial relationships or personal benefit with commercial companies whose products are discussed in the educational presentation. Disclosure of a relationship is not intended to suggest or condone bias in any presentations, but is made to provide participants with information that might be of potential importance to their evaluation of a presentation.

The individual(s) listed below have declared that they have no financial arrangements or affiliations with any corporate organization offering financial support or grant monies for this CME program or with any corporate organization whose product(s) will be discussed in their presentation(s):

The following individual(s) have indicated that they will/may include discussion of investigational or off-label use of products. The following individual(s) have declared financial interest(s) and/or affiliations:

## **ONLINE EVALUATION FOR CME**

To access the online evaluation go to <http://jeffline.jefferson.edu/jeffcme/SNUMCAA/>

### **Instructions for Completing the Online Evaluation**

Please follow the steps below to complete your online evaluation. Use the navigation buttons to move between screens and make your selections.

1. Login Screen
  - \* Enter your username (your last name) and the last four digits of your social security number
  - \* You may use any 4 digits THAT YOU WILL REMEMBER; your credits will be linked to this number
2. Personal Information Screen
  - \* Enter the required personal information (you will only need to do this once)
3. Jefferson Screen
  - \* Read through the information listed.
  - \* Click on the "Continue to Conference Evaluations" link.

#### 4. Main Menu Screen

- \* Select the day of the session you are evaluating.
  - o Identify the time of the session you attended.
  - o Click on “Evaluate Activity” to the left of the times listed.
  - o After completing the evaluation, click on “Submit Evaluation”.

\* Once you have completed all your evaluations, click on “Return to Main Menu” and click on “Conference Overall Evaluation” to evaluate the conference as a whole.

Evaluations will be available at the end of the morning of each day. Conference evaluations will be available at the conclusion of the conference. Note that you must evaluate at least one session in order to access the overall conference evaluation, and that you must complete the overall conference evaluation in order for your credits to accrue.

Evaluations should be completed online no later than July 3rd, 2015.

### **All speakers and presenters of June 5 and June 6 have to complete “Conflict of Interest” declaration.**

Go the following website.

<http://jeffline.jefferson.edu/jeffcme/JeffETC/login.cfm>

Click “For CME Activity Faculty” on the left side menu (4th menu from the top)

Click “Submit Your CME COI online” (This is the second subheading.)

Type in your last name and last 4 digit of your social security number. (no space between your name and the last 4 digits of social security number)

(For those who do not have social security number, you may enter any 4 digit numbers. You have to remember these 4 numbers to log in again and to get CME credit at the end of convention.)

Click “Login Now”

You have to type in your information

First name  
Last name  
Degree  
Title  
Institute  
Address  
City  
State  
Zip code  
Country  
Telephone  
Fax  
E-mail address

For those reside in Korea, you do not have to fill in State and Zip code. However, you have to choose South Korea in the Country section.

Click “Create WEB-ID”,

In the next page, you have to enter several information.

1. Name of CME activity: type in “SNUCMAA 32nd Annual Convention”
2. Date of CME activity: 06/05/2015 or 06/06/2015 depending on your presentation day.
3. Total presentation time: you may enter 15, 30, or 45 min depending on your presentation time.
4. My content involves off label or investigational use of and FDA regulated product.  
Most likely you will choose “NO”.
5. In Check all that apply column, choose  
“Creating Content (presentation, writing)”.

Click, “Save and Continue”

In the next page,

I So Attest, Choose “YES”

Then Click “Save and Continue”



In the next page, choose "I have no relevant financial relationships to disclose".

If you have any grant support or financial support, you have to list them in this page.

At the bottom of the page, you have to click the box left your name for electronic signature.

Then, click "Save and Continus"

All done, and you may exit the database.

**Please remember 4 digit numbers you entered. You can login using your last name  
+4 digit numbers to claim CME credit immediately after the Convention.**

## **CME CERTIFICATES**

CME certificates will be available online beginning June 17th, 2015 for those who have completed the evaluation process at <http://jeffline.jefferson.edu/jeffcme/jeffetc>. CME certificates are only available at this online site and will not be mailed.

Jefferson Electronic Transcripts and Certificates (JeffETC) is a service of the Office of CME that allows participants to conveniently retrieve their CME credit transcripts as needed. To use this service after the conference, simply go to the above link and enter your last name as well as the last four digits of your social security number (or the four digit number previously identified). Here you will find a listing of all Jefferson-sponsored CME activities that you have participated in, and you will be able to print a transcript or individual certificate. Please contact the Jefferson Office of CME at 1-888-JEFF-CME or [jeffersoncme@jefferson.edu](mailto:jeffersoncme@jefferson.edu) if you have any questions.

### **President Forum: Panel discussion.**

East Ballroom at 8:00 - 10:00 A.M. on June 7th, 2015 (Sunday)

All previous presidents & officers are welcomed to participate.

Moderator:

- \* President's report
- \* History of SNUCMAA of NA.
- \* How to select presidents.
- \* How to attract young alums.
- \* How to continue the scientific convention.
  - + Registration fee:
  - + CME:
- \* New Business

1. As the president, what were the hardship and rewards you had?
2. What do you suggest to vitalize SNUCMAA of NA (such as, recruiting more dues-paying members; increasing participation to various SNUCMAA activities; increasing communication among alumni members, etc.)?
3. What should be the future direction of SNUCMAA of NA?

### **Meet the Authors Forum:**

Hospitality room throughout the Convention for exhibition, meeting the authors, book signing and sale.

There will be presentations by a few authors regarding book writing, and the content of his/her book.

Dr. Won Tak Lee, the chairman of publishing committee and the editor-in-chief of Sigetop is the coordinator for these activities. The exact location and time of presentation will be posted.

## **GENERAL INFORMATION**

### **REGISTRATION**

\* Registration Desk will be located at the side entrance, in front of Ballroom A, B & C.

Hours:	Thursday, June 4th	2PM - 11 PM
	Friday, June 5th	7 AM - 11 PM
	Saturday, June 6th	8 AM - 11 PM

<b>* Registration Fee</b>	
Members, Class of '61 or later	\$ 200
Members prior to Class of '60 or in Training	\$ 100
Alums from Korea or Members' Family	Free

**NAME TAGS**

You must bring your name tag for Friday Banquet and Saturday Grand Banquet.

Different color coded stickers will be attached on your name tag. Hotel/yacht attendances will not allow for anyone without the proper color-coded stickers on the name tags for each event.

**BREAKFAST/LUNCH GUIDE**

June 5th (Friday) Breakfast: will be served at the hallway in front of the Ballroom A, B & C between 7:00 and 9:00 A.M. Left-over will be available at the Bergen Hall after 9:00 A.M.

June 5th (Friday) Lunch: will be served in front of the Ballroom A & B at 12:00 P.M for "Luncheon Meeting" attendants.

June 6th (Saturday) Breakfast: will be served at the hallway in front of the Ballroom A, B & C between 7:00 and 9:00 A.M. Left-over will be available at the Bergen Hall after 9:00 A.M.

June 6th (Saturday) Lunch: will be served at the Bergen Room for the GP Forum attendants.

June 6th (Saturday) Lunch: will be served at the buses for the City Tour and Bear Mt. Hiking alums & family.

June 7th (Sunday) Breakfast: will be served at the East Ballroom for President Forum & GP Forum attendants between 8:00 and 10:00 A.M.

June 7th (Sunday) Breakfast: will be served at the Bergen Room for the post-convention tour alums & family between 8:00 and 10:00 A.M.

**GROUND TRANSPORTATION:**

Between JFK, LaGuardia or Newark Airports and Hotel:

Teaneck Limo Service online fares: \$55 Newark Airport (EWR); \$85 JFK Airport (JFK); \$69 LaGuardia Airport (LGA).

Online reservation web-site <http://teanecklimo.com>

\* Phone: 201-708-5599

\* Phone: 1-877-339-6888

\* Email: [info@teanecklimo.com](mailto:info@teanecklimo.com)

**PARKING:**

Hotel Parking: Free parking.

Post-convention tour 기간 동안도 free parking.

**BUSES FROM HOTEL:**

For Manhattan Tour: Buses will leave at 12:00 P.M. on June 6th (Saturday):  
\$40 per person, including lunch (reservation needed).

For Bear Mt. Hiking: Buses will leave at 12:30 P.M. on June 6th (Saturday):  
\$30 per person, including lunch (reservation needed).

For Woodbrige Outlet shopping: Buses will leave at 12:30 P.M. on June 6th (Saturday):  
\$30 per person, including lunch (reservation needed).

For Grand Banquet for Cornucopia Majesty yacht: Buses will leave at 5:50 P.M. on June 6th (Saturday) to Hoboken 14th St. Pier (1301 Sinatra Dr., Hoboken, NJ).

Ferry from W 39th St. Ferry Terminal in Manhattan to Hoboken 14th St. Pier:

Ferry will run every 20 min.: \$9 per person. <http://www.nywaterway.com/Hoboken14thRoute.aspx>

**CAR RENTAL:**

Hotel에는 car rental 사무실이 없습니다. 공항에서 rental 하시거나, Enterprise Car Rental (201-833-2200)에 연락 하시면 hotel에서 pick up이 가능합니다.

**AIRLINE INFORMATION:**

If you need to make, change or reconfirm your reservation, please contact airline directly. Toll free numbers for major airlines are listed below.

* American Airline	800-433-7300	* Asiana Airline	800-227-4262
* Jetblue	800-538-2583	* Continental airline	800-523-3273
* Delta Airline	800-221-1212	* Korean Airline	800-438-5000
* Southwest Airline	800-435-9792	* United Airline	800-864-8331
* US Air	800-428-4322		

**RESTAURANTS NEARBY:**

- \* Mi Ga: 344 Broad Av., Leonia, NJ 07605; 201-461-9111.
- \* Han Bat: 452 Broad Av., Palisades Park, NJ 07650; 201-585-0800.
- \* So Moon Nan Jib: 238 Broad Av., Palisades Park, NJ 07650; 201-944-3998.
- \* MukEunJi: 217 Broad Av., Palisades Park, NJ 07650; 201-363-0600.
- \* So Gong Dong Tofu: 118 Broad Av., Palisades Park, NJ 07650; 201-313-5500.
- \* Mandalin (Chinese): 110 Broad Av., Palisades Park, NJ 07650; 201-313-0121.
- \* Dong Hac Susan: 445 Grand Av., Palisades Park, NJ 07650; 201-461-4447.
- \* Kam Mi Ok: 485 Main St. Fort Lee, NJ 07024; 201-242-1333.
- \* Poonglim: 2053 Lemoine Av. Fort Lee, NJ 07024; 201-944-8699.
- \* Dong Bang Grill: 1616 Palisade Av. Fort Lee, NJ 07024; 201-242-4485.

**About Glenpointe Marriott Hotel:**

The newly renovated Marriott Hotel is located at the crossroads of I-95 and I-80, 3 miles from the George Washington Bridge and 15 minutes from Manhattan. This hotel features a brand new Great Room lobby experience, concierge floors, new Pancetta restaurant and lounge.

**Banquet & Conference Places:**

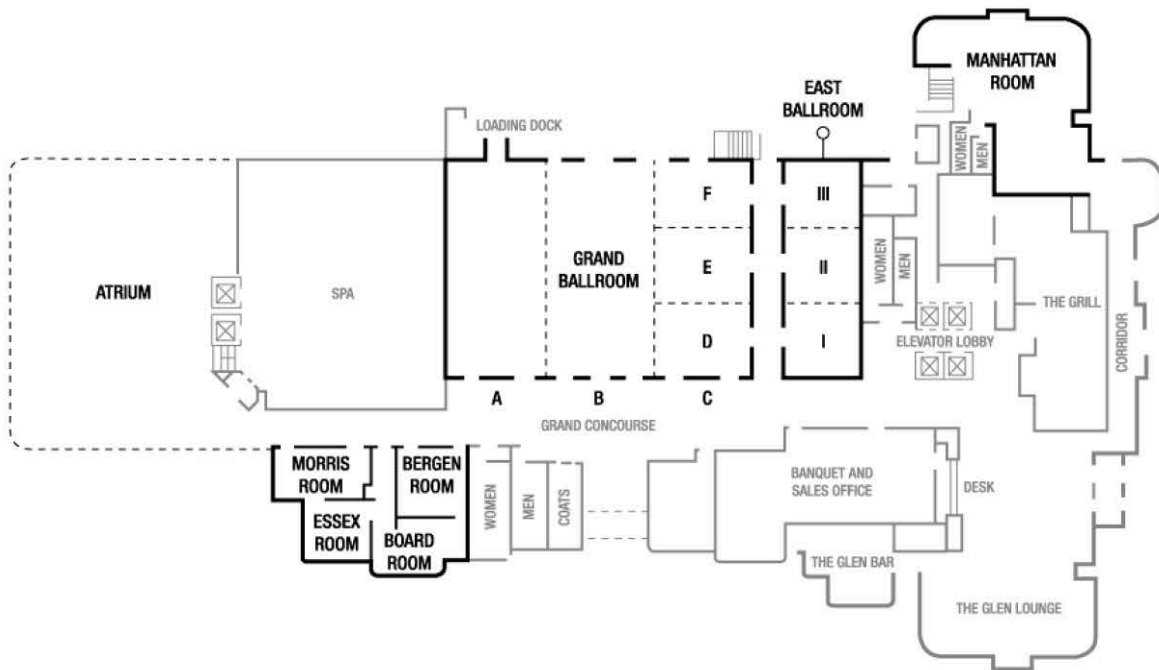

**Post Convention Tour**

**June 7th (Sunday)**

8:00-9:30 AM  
10:00 AM

Continental breakfast & non-CME sessions at the Bergen Room.  
Leave the hotel for the tour.

**June 8th (Monday)**

6:00-8:00 PM

“Home-Coming & Meet the Western NY Local Alums” at Brasa Brazilian Niagara Steakhouse. <http://www.brasaniagara.com/>

**June 10th (Wednesday)**

12:00-2:00 PM

“Home-Coming & Meet the Albany NY Local Alums” during Lake George Steamboat Cruise Luncheon.

6:00-7:00 PM

Arrives at the hotel from the tour.

## FACULTY

- Ahn, Kyung-Heup Ahn, M.D. (1996)**  
Assistant Professor, Department of Psychiatry, Yale School of Medicine, New Haven, CT
- Ahn, Hyo Seop, M.D. (1971)**  
Professor Emeritus of Seoul National University College of Medicine  
Professor, Cancer Center, Bundang Seoul National University Hospital, Seoul, Korea
- Auh, Yong Ho, M.D. (1972)**  
Professor of Radiology, Cornell University Weill Medical College, New York, NY
- Choh, Joong-Haeng, M.D., FACS (1969)**  
Cardiothoracic and Vascular Surgical Associates, Chicago, IL  
Medical Director, International Health Care Center  
Seoul National University Bundang Hospital, Seoul Korea
- Choi, John, M.D. (1964)**  
Hematology/Oncology, Poinciana, FL
- Choi, Yong-Sung, M.D. (1961)**  
Distinguished Investigator, Ochsner Clinic Foundation, New Orleans, LA
- Choi, Young Ja, M.D. (1966)**  
Professor, Pathology and Lab Medicine, Yale School of Medicine, New Haven, CT
- Choi, Taewoong, M.D. (2002)**  
Hematology/Oncology Fellow, Division of Hematology-Oncology,  
Department of Medicine, University of Pittsburgh Medical Center, Pittsburgh, PA
- Chung, June-Key, M.D. (1977)**  
Professor, Department of Nuclear Medicine  
Past Director, Institute of Medical History and Culture, SNUH, Seoul, Korea
- Hahn, Chang-Gyu, M.D. (1981)**  
Director, Neuropsychiatric Signaling Program, Center for Neurobiology and Behavior  
Department of Psychiatry Translational Research Laboratories, Philadelphia, PA
- Hann, Hie-Won L., M.D., FAASLD (1961)**  
Professor, Hepatology, Thomas Jefferson University, Philadelphia, PA
- Huh, Won Jae, M.D. (2002)**  
Gastrointestinal/Liver Pathology fellow, Vanderbilt University Medical Center, Nashville, TN
- Jang Sekwon, MD (2001)**  
Director, Melanoma and Cutaneous Oncology Therapeutics and Research  
Inova Comprehensive Cancer and Research Institute, Fairfax, VA
- Jeong, Youngtae, M.D. (2001)**  
Postdoctoral fellow  
Stanford Cancer Institute and Institute for Stem Cell and Regenerative Medicine, Stanford, CA
- Joung, Kyoung Eun, M.D. M.M.Sc. (2002)**  
Neonatologist, Goryeb Children's Hospital, Morristown, NJ  
Research Fellow, Beth Israel Deaconess Medical Center, Boston, MA
- Kang, Daehee, M.D. (1987)**  
Professor and Dean, Seoul National University College of Medicine, Seoul, Korea
- Kang, Yoogoo, M.D. (71)**  
Professor and Vice Chairman of Research, Department of Anesthesiology  
Director, Hepatic Transplantation Anesthesiology, Department of Anesthesiology
- Kim, Damian Byungsuk, M.D. (1959)**  
Associate Clinical Professor, St. George University  
Director, OPD of Psychiatry at Coney Island Hospital, Brooklyn, NY
- Kim, Junghoon, M.D. (1999)**  
Assistant Professor, Geriatrics, Department of Medicine  
Baylor College of Medicine, Dallas, TX

## FACULTY

- Kim, Tae Kon, M.D. (2001)**  
Clinical fellow, Medical Oncology/Hematology  
Department of Internal Medicine, Yale University School of Medicine,  
Smilow Cancer Hospital at Yale-New Haven Hospital, New Haven, CT
- Kim, Yuhree, M.D., M.P.H. (2011)**  
Postdoctoral Research Fellow  
Department of Surgical Oncology, Johns Hopkins Hospital, Baltimore, MD
- Lee, Peter Kang-Woo, M.D., Ph.D. (1974)**  
Professor Emeritus of SungKyunKwan Univ. of School of Medicine, Seoul, Korea  
President, Daegu Workers' Compensation Hospital, Daegu, Korea
- Lee, Sunhee C, M.D. (1981)**  
Professor of Pathology, Albert Einstein College of Medicine, Bronx, NY
- Lee, Tae Hoon, M.D. (2002)**  
Fellow (PGY4), Div. of Gastroenterology and Hepatology  
MetroHealth Medical Center, Case Western Reserve University, Cleveland, OH
- Nam, Young-Jae, M.D. (1994)**  
Assistant Professor, Department of Medicine and Cell and Developmental Biology,  
Vanderbilt Center for Stem Cell Biology, Vanderbilt University School of Medicine, Nashville, TN
- Oh, Byung-Hee, M.D., Ph.D., FACC (1977)**  
Professor of Internal Medicine, Seoul National University Hospital, Seoul, Korea
- Oh-Park, Mooyeon, M.D. (1989)**  
Associate Professor of Physical Medicine and Rehabilitation,  
Rutger New Jersey Medical School, Newark, NJ
- Park, Eunkyung, M.D. (2000)**  
Associate Research Scientist  
PET Center, Department of Diagnostic Radiology, Yale School of Medicine, New Haven, CT
- Park, C Lucy, M.D. (1975)**  
Professor of Pediatrics, Allergy and Immunology, University of Illinois, Chicago, IL
- Park, Young Su, M.D. (2008), M.A. (2012)**  
Doctoral Candidate, Department of Anthropology, Stanford University, Stanford, CA
- Seo, In Suk, M.D. (1973)**  
Director, Nuclear Medicine, The Brooklyn Hospital Center, Brooklyn, NY
- Song, Kyung Min, M.D., MPH, MBA (2009)**  
Manager, Evidence, Translation, & Implementation  
Avalere Health LLC, Washington DC
- Suh, Yoo-Hun, M.D., Ph.D. (1973)**  
President, Korea Brain Research Institute (KBRI)  
Professor Emeritus, Seoul National University College of Medicine, Seoul, Korea
- Suk, Jiyoung, Ph.D. (Daughter of Suk, Chang Ho, M.D., 1972)**  
Harvard Law School, Boston, MA
- Woo, Janghee, M.D. (2004)**  
Fellow, Hematology/Oncology,  
Fred Hutchinson Cancer Research Center, University of Washington, Seattle, WA
- Yi, (Joanne) Eunhee Suh, M.D. (1982)**  
Professor and Consultant of Pathology,  
Mayo Clinic College of Medicine, Rochester, MN
- Yim, Jae-Joon, M.D. (1988)**  
Professor and Chief, Division of Pulmonary and Critical Care Medicine,  
Department of Internal Medicine, Seoul National University College of Medicine, Seoul, Korea

## SCIENTIFIC SESSION (Category 1 CME)

### June 5 (Friday)

- 7:00 - 9:00 Breakfast  
7:40 - 7:47 Welcome to the Scientific Session  
In Suk Seo, M.D. (1973), President of SNUCMAA of NA  
John Choi, M.D. (1964), Convention Chair  
Jung Yong Hong, M.D. (1975), President of SNUCMAA  
7:47 - 7:50 Opening Remarks  
Yoogoo Kang, M.D. (1971), Scientific Committee Chair
- Moderator: Yoogoo Kang, M.D.**  
7:50 - 8:15 Antiviral Therapy for Chronic Hepatitis B: Is the Cure attainable?  
Hie-Won L. Hann, M.D., FAASLD (1961)  
8:15 - 8:40 Heart Failure in Korea  
Byung-Hee Oh, M.D., Ph.D., FACC (1977)  
8:40 - 9:20 Surgeon and Art  
Joong-Haeng Choh, M.D., FACS (1969)  
9:20 - 9:45 Gastro-Esophageal Reflux Disease, Barrett's Esophagus & Esophageal Cancers  
Young Choi, M.D. (1966)  
9:45 - 10:20 Pathogenesis and Therapy for Alzheimer's disease and Introduction of Korean  
Brain Research Institute  
Yoo-Hun Suh, M.D., Ph.D. (1973)  
10:20 - 10:35 Coffee break
- Moderator: Chang-Gyu Hahn, M.D. (Scientific Committee Co-Chair)**  
10:35 - 11:00 Biomarkers for Diagnosis and Treatment of Lung Cancers: Update in 2015  
(Joanne) Eunhee Suh Yi, M.D. (1982)  
11:00 - 11:15 Pharmacological Modeling of GABA Deficit in Schizophrenia. [Abstract]  
Kyung-Heup Ahn, M.D. (1996)  
11:15 - 11:30 Osteoporosis in Geriatric Patients [Abstract]  
Junghoon Kim, M.D. (1999)  
11:30 - 11:45 The role of Trp53 and the Keap1-Nrf2 Pathway in Airway Stem Cell Self-renewal  
and Lung Squamous Cell Carcinoma Pathogenesis [Abstract]  
Youngtae Jeong, M.D. (2001)  
11:45 - 12:00 The Roles of Quality Measures in the Value-Focused Healthcare System  
Kyung Min Song M.D., MPH, MBA (2009)  
12:00 - 12:25 Immunotherapy of Cancer  
Yong-Sung Choi, M.D. (1961)  
12:25 - 1:05 Luncheon Meeting: Medical Economy Update  
1:05 - 1:45 **Kang Shinho Lectureship**  
Yoogoo Kang, M.D. (1971)
- Moderator: Hyo Seop Ahn, M.D. (71)**  
1:45 - 2:10 Acute Lymphoblastic Leukemia in Children: Past, Present and Future  
Hyo Seop Ahn, M.D. (1971)  
2:10 - 2:35 Diagnosis and Effective Management of Adhesive Capsulitis (Frozen Shoulder)  
Peter Kang-Woo Lee, M.D., Ph.D. (1974)  
2:35 - 3:00 Historical Sites in Yongon Campus of Seoul National University  
June-Key Chung, M.D. (1977)  
3:00 - 3:15 Coffee break
- Moderator: Yong Ho Auh, M.D. (1972), Convention Co-Chair**  
3:15 - 3:40 Therapeutic Alliance in Clinical Practice  
Damian Byungsuk Kim, M.D. (1959)  
3:40 - 4:05 Inhaled Corticosteroid and Tuberculosis among Patients with Chronic Airway Disease  
Jae-Joon Yim, M.D. (1988)  
4:05 - 4:20 SNUCM Library Campaign  
Jae-Joon Yim, M.D. (1994)  
4:20 - 4:25 Announcement  
Yong Ho Auh, M.D. (1972), Convention Co-Chair  
6:00 - 11:00 Banquet at Grand Ballroom A & B

## SCIENTIFIC SESSION (Category 1 CME)

### June 6, 2015 (Saturday)

7:00 - 9:00 Breakfast  
7:45 - 7:50 Announcement  
Chang-Gyu Hahn, M.D. (1981), Scientific Committee Co-Chair

#### Moderator: Sunhee Lee, M.D. (1981), Publication Committee

7:50 - 8:15 SNUCM: Past, Present, and Future  
Daehee Kang, M.D. (1987)  
8:15 - 8:30 11C-PBR28 PET Imaging in Multiple Sclerosis Patients and Healthy Controls:  
Test-retest reproducibility and focal visualization of active white matter areas  
Eunkyung Park, M.D. (2000)  
8:30 - 8:45 MEK Inhibitors Selectively Suppress Alloreactivity and Graft-versus-Host  
Disease in a Memory Stage-dependent Manner  
Tae Kon Kim, M.D. (2001)  
8:45 - 9:00 Emerging Therapies for Melanoma  
Sekwon Jang, MD (2001)  
9:00 - 9:15 Epithelial Mesenchymal Transition in Micropapillary Colorectal Carcinoma  
Won Jae Huh, M.D. (2002)  
9:15 - 9:30 Coffee break

#### Moderator: Mooyeon Oh-Park, M.D. (1989), Green Project Committee Chair

9:30 - 9:55 Legal Consequences of Post-Traumatic Stress Disorder  
Jiyoung Suk, Ph.D.  
9:55 - 10:10 Non-receptor Tyrosine Kinase c-Src Activity and Cetuximab Response in  
Metastatic Colorectal Cancer  
Janghee Woo, M.D. (2004)  
10:10 - 10:25 Cord Blood Levels of Adipocyte Fatty Acid Binding Protein (AFABP) are related to  
Birth Weight and Gestational Age in Newborn Infants  
Kyoung Eun Joung, M.D. M.M.Sc. (2002)  
10:25 - 10:40 The Role of Exosomes in Cytotherapy for Acute Myelogenous Leukemia  
Taewoong Choi, M.D. (2002)  
10:40 - 10:55 Conditional Survival after Surgical Resection of Gastric Cancer:  
A Multi-Institutional Analysis of 807 Patients  
Yuhree Kim, M.D., M.P.H. (2011)

#### Moderator: Young-Jae Nam, M.D. (1994), Green Project Committee

10:55 - 11:20 Why are Allergic Disorders More Prevalent in Developed Countries?  
C Lucy Park, M.D. (1975)  
11:20 - 11:35 Transplanting Korean Development Model to Africa: South Korean NGOs'  
Family Planning Projects in Ethiopia  
Young Su Park, M.D. (2008), M.A. Anthropology (2012)  
11:35 - 11:50 Serum Aminotransferase Activity and Comorbidities in US Veterans  
Tae Hoon Lee, M.D. (2002)  
11:50 - 12:05 Reprogramming Specific Cardiac Cell Fates: New Paradigm for Heart Repair  
Young-Jae Nam, M.D. (1994)  
12:05 - 12:15 Closing Remarks  
In Suk Seo, M.D. (1973), President, SNUCMAA of NA  
Yong Ho, Auh, M.D. (1972), Convention Co-Chair  
Yoogoo Kang, M.D. (1971), Scientific Committee Chair

## NON-CME SESSION

### June 5th (Friday)

7:50 - 8:30	국영순 <b>Moderator: Tina Han</b>	대합창 연습
8:30 - 8:35	서인석	Non-CME 소개 및 인사의 말씀
8:35 - 9:05	안신영	Introduction of Arts Exhibit
9:05 - 9:30	Dr. Hie-Won Hann (61)	On Opera
9:30 - 10:25	Dr. Hong Bin Lee (63)	On Wine
10:25 - 10:40		Coffee Break
10:40 - 11:20	Yongjin Kang	1. On Millenials / 2. Raising Grandchildren in a Diverse Society
11:20 - 12:05	Dr. Kei Chul Ohn (71)	History of the US-Korea Relations prior to and after 1945 (I)
12:05 - 1:05	Luncheon Meeting	"Medical Economy Update" Presenter: Ed Lange
1:05 - 1:50	Dr. Kei Chul Ohn (71)	History of the US-Korea Relations prior to and after 1945 (II)
1:50 - 2:20	Dr. Yong Sung Choi (61)	Birds in Korea
2:20 - 3:00	Dr. Myong Won Kim (68)	Drawing with Computer
3:00 - 4:00	Dr. Chun Ki Kim	음악 이야기 with Playing Guitar
4:00 - 5:00	국영순	대합창 연습

### June 6th (Saturday)

	<b>Moderator: Yongjin Kang</b>	
7:50 - 8:30	Eun Han Kim (66)	신라의 황금문화
8:30 - 9:15	Dr. Soo Shin Kim (75)	Current Trends in Plastic Surgery
9:15 - 9:30		Coffee Break
9:30 - 9:55	Dr. C. Lucy Park (75)	우리의 찬란한 보물, 시조
9:55 - 10:25	Mr. Joong S. Park	컴퓨터 기본상식
10:25 - 11:00	Dr. David Lah (73)	On Photography
11:00 - 11:30	Ji Young, Suk	Sexual Assault Policies on University Campuses

### June 7th (Sunday)

8:00 - 8:40	Dr. Eun Han Kim (66)	훈족의 원류는 신라 가야인가?
8:40 - 9:20	Dr. Kei Chul Ohn (71)	자본주의 (How Capitalism Works?)

### Faculty of Non-CME

Mrs. John Baek (안신영)	syantpainter@gmail.com; 201-724-1394 (cell)
Dr. Hong Bin Lee (63)	drhblee@gmail.com; (201) 240-9649 (cell)
Dr. Hie-Won Hann (61)	hie-won.hann@jefferson.edu
Mrs. Wun Jung Kim (75; 강용진)	yjinkng@msn.com
Dr. Andrew K. Choi (76)	thevipsurgery@gmail.com, akchoi52@gmail.com; (626) 818-4013 (cell)
Dr. Kei Chul Ohn (71)	jamesunohn@comcast.net; 209-968-3926 (cell)
Dr. Yong Sung Choi (61)	zenc75@gmail.com; (504) 913-1035 (home)
Dr. Myong Won Kim (68)	myongwonk@gmail.com; 714-329-3500 (cell)
Dr. Chun Ki Kim; Prof. at Brigham Womens.	ckkim@bwh.harvard.edu; 914-420-9848 (cell)
Dr. Eun Han Kim (66)	eunhankim@hotmail.com; 617-548-9923 (cell)
Dr. Soo Shin Kim (75)	kim1624@hotmail.com; 010-4757-1616
Dr. Lucy C. Park (75)	uic3549@gmail.com;
Mr. Joong S. Park	joongpark@msn.com; 813-667-1008 (home); 215-260-5041 (cell)
Dr. David Lah (73)	ddlah@msn.com; 909-912-4613
Jeannie Ji Young Suk; Harvard Law Prof.	jsuk@law.harvard.edu
Mrs. Michael Lee (66; 국영순)	Yskook31@aol.com; 914-844-3212 (cell).

### Non-CME Co-chairs:

Mrs. Min Woo Han (75)	tinahan34@gmail.com; 201-704-7085 (cell)
Mrs. Wun Jung Kim (75)	yjinkng@msn.com; 734-717-1953 (cell)





**Jasung Kim (85) Psychiatry**  
 Lincoln Regional Center, Staff Psychiatrist  
 \* Green Project entertainment leader

1985-1989 Psychiatry Residency at SNUH  
 1992-1993 Child Psychiatry fellowship at SNUH?  
 1993-1994 Seoul National Mental Hospital  
 1994-1995 Instructor, DanKuk University  
 1995-1998 New York Hospital Cornell Med Center, Psychiatry Residency  
 1998-1999 Yale University Fellowship in Brain imaging/schizophrenia program  
 1999-2000 University of North Dakota Clinical Professor  
 2000-2011 Lincoln Nebraska private practice?  
 2011-2014 Dong Hae Dong-In hospital psychiatrist, Korea?  
 2014 Lincoln Regional Center staff psychiatrist, Lincoln, NE.



**\*Chun Ki Kim (80 한양의대)**

Harvard Medical School/Brigham and Women's Hospital  
 Department of Radiology

\* Green Project entertainment leader  
 \* Candidate for honorary membership of SNUCMAA of NA and  
 Speaker of non-CME program "음악이야기" with playing guitar

김천기 교수는 경기도 (1972) 와 한양의대(1980)를 졸업하고, 도미하여 University of Rochester의대, Albert Einstein의대, 그리고 UPenn의대를 거치며 핵의학 전공의/전임의 과정을 마쳤다. 1987년에 뉴욕 Mount Sinai 의대에 faculty로 임용된 후, UPenn, University of Maryland를 거쳐, 현재 Harvard의대 Brigham and Women's Hospital의 분자영상핵의학과에 Clinical Director 로 재직중이다. 그동안 다수 학술지의 Editorial Board 멤버로, 또는 학회의 committee 위원으로 기여를 해왔고, 최근에는 American Board of Nuclear Medicine의 Board of Directors 멤버로서의 임기를 마친 후 보드의 Life member로 선정되었다. 김 교수는 지금껏 한국인들에 대한 특별한 애정을 가지고 많은 한인 의사들에게 formal residency training, 혹은 research training의 자리를 제공하여 그들의 장래에 도움을 주어왔고, 그 중 서울의대 동문들도 다수 포함되어있다.

한편 김 교수는 우리나라 록음악계의 거장이자 legend로 일컬어지는 전인권과 그룹 <들국화>의 오랜 음악친구로 최근까지도 때때로 그들의 스페셜 게스트로 무대에 함께 올랐으며, 최근에 출판된 그들의 새 앨범에 세션기타리스트와 백보컬리스트로도 참여하였다. 또한 클래식음악도 열렬히 사랑하는 김 교수는 Boston Symphony Hall의 무대에서 그가 특히 사랑하는 구스타프 말러의 2번교향곡의 합창에 참여하는 감동적인 경험도 하였다. 이렇듯 다양한 음악을 사랑하는 김 교수는 이번 컨벤션에서 "많은 음악들 중에도 보다 더 오묘하고 아름답게 들리는 음악은 무엇때문?" "차원이 한단계 더 높아진 음악은 어떤 음악?" "음악을 아름답게 만드는 <불협화음>의 역할" "수학과 음/화음의 신비로운 관계" 등의 주제를 가지고, 우리의 귀에 친숙한 클래식곡, 성가, 팝송/가요들을 예로 들어 그 곡들에서 발췌한 부분을 mp3로 직접 듣기도 하고, 부분적으로 화음/화성을 비교/설명해야할 필요가 있는 곳은 직접 기타연주를 해가며, 그가 사랑하는 음악이야기를 펼칠 예정이다.

## GREEN PROJECT FORUM

### June 5th, 2015, Saturday

- 12:15-1:15 Lunch  
12:45-1:45 Private Practice Building (overlap with lunch)  
**Moderator: Wonsock Shin, MD (1988)**  
Panel: Sung-Eun Yoo, MD (1994), In Bo Shim, MD (1983)  
Wonsock Shin, MD (1988)
- 1:45-2:00 Break  
2:00-3:45 Research Career Development  
**Moderator: Chang-Gyu Hahn, MD, PhD (1981), Young-Jae Nam, MD, PhD (1994)**  
3:45-4:00 Introduction of Gastric Cancer Project: Chan Hyung Park, MD (1962)

### June 6th, 2015, Sunday

- 8:00-10:00 GP Forum Open Discussion with Breakfast  
**Moderator: Mooyeon Oh-Park, MD (1989), Sunhee Lee, MD (1981)**  
Reflection on Convention  
Past, Present, and Future of GP  
Women in Medicine & Science  
Collaboration with SNUCM  
**Moderator: Eun Yong, MD (2014)**  
Communications, Social Networking Services

#### Sung-Eun Yoo (94) Endocrinology

\*Green Project "Medical Practice Building" Panel Discussant



Sung-Eun Yoo, MD, FACE, is a graduate of Seoul National University Medical School in 1994. After graduation and internship at the Seoul National University hospital, she moved to Boston, MA. She trained as a postdoctoral fellow in the division of Endocrinology, Beth-Israel Hospital from 1995 to 1997. Subsequently she completed an internship and residency program in internal medicine at the University of Cincinnati Medical Center, followed by fellowship training in endocrinology, diabetes and metabolism at the University of Cincinnati medical center and University of North Carolina- Chapel Hill.

Dr. Yoo has held a position of clinical assistant professor of medicine in the division of Endocrinology at University of North Carolina, Chapel Hill from 2006 to 2011 until she opened her private endocrine practice "Cary Endocrine & Diabetes Center (CEDC)" in September, 2011 in Cary, NC. The first and only endocrinology practice in Cary, CEDC is led by Sung-Eun Yoo, MD along with two mid-level providers (nurse practitioner and physician's assistant) and is a full-service endocrinology practice offering diagnosis and treatment of all types of endocrine problems and metabolic disease ? diabetes, thyroid disease, osteoporosis, adrenal insufficiency, PCOS, tumors of the endocrine organs, lipid disorders and male hypogonadism. Dr. Yoo is certified in neck ultrasound and has the expertise to perform neck and thyroid ultrasound and ultrasound-guided fine-needle aspiration. She also has the International Society for Clinical Densitometry (ISCD) certification for diagnosis of osteoporosis.

Dr. Yoo is also founder and chair of Luke Charity Clinic, a faith-based outreach of physician, nurse and non-medical volunteers that provides basic medical care to the uninsured and low-income Korean/Asian populations. Since its inception in 2006, the free clinic, operated by Dr. Yoo and her team of volunteers, has served as the medical home for over 1,000 underprivileged Korean patients. In December 2010, Luke Charity Clinic was incorporated, a volunteer Board of Directors was formed and the bylaws were approved. Federal 501(c)(3) non-profit status was approved in April, 2011. Luke Charity Clinic holds monthly free clinic, CV annual screening event, and annual multispecialty Korean health fair.

**Shim, In Bo (83) Cardiology**

**\*Green Project "Medical Practice Building" Panel Discussant**



07-1986 to 06-1989 Resident, Internal Medicine Lutheran Medical Center, Brooklyn, NY  
 07-1989 to 06-1991 Fellow, Cardiology  
 The Brooklyn Hospital Center, Brooklyn, NY  
 07-1991 to 07-1992 Director, Cardiology section of Caledonian Campus  
 The Brooklyn Hospital Center, Brooklyn, NY  
 08-1992 to present Consulting Cardiologist,  
 Private Practice of Cardiology  
 Cardiology Consultants of Bay Ridge, P.C.  
 237 82nd Street, Brooklyn, NY 11209  
 06-2011 to present Consulting Cardiologist,  
 Private Practice of Cardiology  
 Cardiology Consultants of Englewood Cliffs, P.C.  
 700 E. Palisade Ave, Englewood Cliffs, NJ 07632

**Wonsock Shin (88) Internal Med.**

**\*Green Project "Medical Practice Building" Panel Discussion Leader**

**Secretary-elect 2015-2016**



Dr. Wonsock Shin is board certified in Internal medicine and Geriatric Medicine. He is a graduate of Seoul National University College of Medicine with Honors in 1988. He completed Internship and residency in Internal Medicine at Seoul National University hospital and was board-certified in internal medicine.

He served in the Korean Army for the next 3 years like all the other healthy young Korean males. He served as a Medical Officer at the 3rd infantry division of Korean Army. For the next two years, He was assigned to US Army 43rd Mobile Army Surgical Hospital at Camp Humphreys, Pyongtaeck, Korea.

Following his military service, Dr Shin moved to Framingham, MA, as an intern in internal medicine, and completed his residency at the same-named hospital. Boston University Geriatrics Fellowship was one of his highlights of his career: he was a clinical fellow at the University Hospital and also a teaching fellow at the Boston University School of Medicine. He also completed his Master of Public Health degree at the Boston University School of Public Health during his geriatrics fellowship training.

He started his practice in Internal Medicine and has been serving people in Cumberland, MD since 2000. He also served as a medical director of a nursing Home in the area. He was recently nominated for a Physician of the Year Award by Western Maryland Health System. He recently opened a new internal medicine practice in Vienna, VA.

**Yong Eun (14)**

MIRBC, Massachusetts General Hospital - Harvard Medical School, Boston, MA

**\*Green Project forum (Social Networking Services Subcommittee) panel discussant**

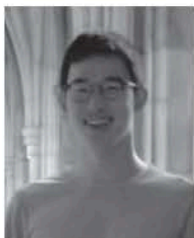

Soon after he graduated from the SNUCM, Dr. Yong Eun started his postdoctoral fellowship at the Mucosal Immunology and Biology Research Center (MIRBC) in the department of Pediatrics at Massachusetts General Hospital and Harvard Medical School. His research employs RNAi screening in *C. elegans* to identify novel tumor suppressor genes and associated pathways.

**PRESIDENT FORUM**

**June 6th, 2015, Sunday**

8:00 - 10:00 Open Discussion with Breakfast  
Moderator: In Suk Seo, M.D. (73)

## CME PROGRAMS / JUNE 5, 2015

- 7:00 - 9:00 Breakfast
- 7:40 - 7:47 Welcome to the Scientific Session  
In Suk Seo, M.D. (1973), President of SNUCMAA of NA  
John Choi, M.D. (1964), Convention Chair  
Jung Yong Hong, M.D. (1975), President of SNUCMAA
- 7:47 - 7:50 Opening Remarks  
Yoogoo Kang, M.D. (1971), Scientific Committee Chair
- Moderator: Yoogoo Kang, M.D.**
- 7:50 - 8:15 Antiviral Therapy for Chronic Hepatitis B: Is the Cure attainable?  
Hie-Won L. Hann, M.D., FAASLD (1961)
- 8:15 - 8:40 Heart Failure in Korea  
Byung-Hee Oh, M.D., Ph.D., FACC (1977)
- 8:40 - 9:20 Surgeon and Art  
Joong-Haeng Choh, M.D., FACS (1969)
- 9:20 - 9:45 Gastro-Esophageal Reflux Disease, Barrett's Esophagus & Esophageal Cancers  
Young Choi, M.D. (1966)
- 9:45 - 10:20 Pathogenesis and Therapy for Alzheimer's disease and Introduction of Korean  
Brain Research Institute  
Yoo-Hun Suh, M.D., Ph.D. (1973)
- 10:20 - 10:35 Coffee break
- Moderator: Chang-Gyu Hahn, M.D. (Scientific Committee Co-Chair)**
- 10:35 - 11:00 Biomarkers for Diagnosis and Treatment of Lung Cancers: Update in 2015  
(Joanne) Eunhee Suh Yi, M.D. (1982)
- 11:00 - 11:15 Pharmacological Modeling of GABA Deficit in Schizophrenia. [*Abstract*]  
Kyung-Heup Ahn, M.D. (1996)
- 11:15 - 11:30 Osteoporosis in Geriatric Patients [*Abstract*]  
Junghoon Kim, M.D. (1999)
- 11:30 - 11:45 The role of Trp53 and the Keap1-Nrf2 Pathway in Airway Stem Cell Self-renewal  
and Lung Squamous Cell Carcinoma Pathogenesis [*Abstract*]  
Youngtae Jeong, M.D. (2001)
- 11:45 - 12:00 The Roles of Quality Measures in the Value-Focused Healthcare System  
Kyung Min Song M.D., MPH, MBA (2009)
- 12:00 - 12:25 Immunotherapy of Cancer  
Yong-Sung Choi, M.D. (1961)
- 12:25 - 1:05 Luncheon Meeting: Medical Economy Update
- 1:05 - 1:45 **Kang Shinho Lectureship**  
Yoogoo Kang, M.D. (1971)
- Moderator: Hyo Seop Ahn, M.D. (71)**
- 1:45 - 2:10 Acute Lymphoblastic Leukemia in Children: Past, Present and Future  
Hyo Seop Ahn, M.D. (1971)
- 2:10 - 2:35 Diagnosis and Effective Management of Adhesive Capsulitis (Frozen Shoulder)  
Peter Kang-Woo Lee, M.D., Ph.D. (1974)
- 2:35 - 3:00 Historical Sites in Yongon Campus of Seoul National University  
June-Key Chung, M.D. (1977)
- 3:00 - 3:15 Coffee break
- Moderator: Yong Ho Auh, M.D. (1972), Convention Co-Chair**
- 3:15 - 3:40 Therapeutic Alliance in Clinical Practice  
Damian Byungsuk Kim, M.D. (1959)
- 3:40 - 4:05 Inhaled Corticosteroid and Tuberculosis among Patients with Chronic Airway Disease  
Jae-Joon Yim, M.D. (1988)
- 4:05 - 4:20 SNUCM Library Campaign  
Jae-Joon Yim, M.D. (1994)
- 4:20 - 4:25 Announcement  
Yong Ho Auh, M.D. (1972), Convention Co-Chair
- 6:00 - 11:00 Banquet at Grand Ballroom A & B

## **Antiviral Therapy for Chronic Hepatitis B: Is the Cure attainable?**

**Hie-Won L. Hann, M.D., FAASLD (1961)**

Professor, Hepatology, Thomas Jefferson University, Philadelphia, PA

Since the discovery of Hepatitis B virus (HBV) by Blumberg in 1965, there has been tremendous progress in the field of HBV in the past 50 years. In 1920, Dane et al. identified the whole virus particle, and Magnius et al. noted hepatitis B e-antigen (HBeAg) in 1972. By the early 1980's, the genome of HBV had been sequenced. The first plasma vaccine, initiated by Millman and Blumberg and developed by Hilleman et al. became available in 1983. The vaccine was rightly designated "The First Cancer Vaccine" by World Health Organization. The close link between HBV and hepatocellular carcinoma (HCC) was lucidly documented by Beasley et al. in their historical prospective study of 22,707 men in Taiwan.

People infected with HBV are at risk of developing liver cirrhosis and HCC with 15% to 40% of individuals developing serious sequelae. Despite the implementation of effective universal vaccination programs, over 350 million people are still chronically infected with HBV worldwide with 75% of them residing in the Asia-Pacific region. In the US, HBV infection is prevalent among immigrants from the endemic regions.

Although hepatocarcinogenesis associated with HBV infection is not completely understood, studies have suggested that the integration of HBV DNA into the host DNA can lead to rearrangement of chromosomes, deregulation and instability of gene expression contributing to oncogenesis. The virus itself may also play a direct role via viral proteins such as the HBx protein, a viral regulator gene, which has been implicated to alter host gene expression. Chronic hepatocyte injury with inflammation, cytokine release and fibrosis may also play a role in carcinogenesis.

Following the advent of oral anti-viral drugs (since 1998), namely the nucleos(t)ide analogues (NA's), there have been significant advances in the management of HBV related diseases including cirrhosis and HCC. Furthermore, studies have demonstrated that anti-HBV therapy appears to prevent and reverse the cirrhotic process and reduce the development of HCC. Furthermore, anti-HBV therapy prevents HCC recurrence after local treatment including surgical resection and loco-regional therapy or transplantation. This is especially important as it may impact the burden of liver transplantation in the face of desperate shortage of liver grafts. Significantly, in recent years in the United States, a decline of liver transplantation was observed for patients with decompensated liver disease secondary to HBV.

In spite of this success, complete elimination of the virus has not been achieved necessitating a nearly life long antiviral treatment for the patients. Nevertheless, the research for eradication of the virus is in progress such as blocking the HBV receptor of the hepatocytes and preventing new infection, enhancing the host immune reactivity combined with antiviral drug and vaccination, or direct attack to the cccDNA in the hepatocyte nucleus and several others as well. It is hoped that eradication of HBV would be a reality in the near future.

## **Heart Failure in Korea**

**Byung-Hee Oh, M.D., Ph.D., FACC (1977)**

Professor of Internal Medicine, Seoul National University Hospital, Seoul, Korea

Heart failure (HF) is a progressive condition in which the heart muscle is unable to pump enough blood through to meet the body's needs for blood and oxygen. The patient experiences fatigue and breathing problems. The prevalence of HF has been increasing in Korea (0.45% in 2002 and 0.62% 2010), and its influence on mortality, morbidity and the health care cost is growing (medical costs of HF have increased 50% from 2009 to 2013 years, the mean cost for hospital care was 7,000 US dollars). HF primarily affects elderly people with incidence rates increasing with age. Since Korea is expected to be an "aged society" by 2017 and is becoming older most rapidly in the world, the health burden of HF in Korea will surge in the near future. To improve the care system and to reduce the burden it is critical to understand the characteristics, hospital courses and outcomes of HF patients, current trends of management including adherence to evidence-based therapy for HF, and the factors affecting outcomes and management of the patients.

We have two large HF cohorts in Korea, Korean Heart Failure registry with 3,200 patients (KorHF 2004-2009) and Korean Acute Heart Failure registry with about 5,600 patients (KorAHF 2011-2014), and they clearly demonstrate the past and the present status of HF in Korea. These registries revealed that HF is a serious condition with in-hospital mortality of 5%, median hospital stay of 9 days, and 1-year mortality of 20%. Their comparison with the registries from other regions of the world will expose geographic variations in epidemiology of HF, and any regional and racial differences would influence the interpretation of the results of clinical trials enrolling primarily non-Asian subjects. In addition to general characteristics of HF in Korea, we will also focus on unique features of HF treatment in Korea including favorable long-term survival rate of heart transplantation recipients and usage of peripheral blood stem cell therapy.

Finally, this lecture will describe that HF is a serious health problem associated with high mortality and significant medical costs in Korea as in other countries, while there are significant differences in characteristics, management, and risk factors affecting the outcomes of HF.

## Surgeon and Art

**Joong-Haeng Choh, M.D., FACS (1969)**

Cardiothoracic and Vascular Surgical Associates, Chicago, Ill  
Medical Director, International Health Care Center  
Seoul National University Bundang Hospital, Seoul Korea

In the history of medicine, there are many physicians who made exceptional accomplishments addressing social issues or excelling in the areas of music, art, literature, theology, or other fields of liberal arts. Several famous names easily come to mind, such as a physician composer Alexander Borodin, an organist and Bach musicologist Albert Schweitzer, a dramatist Anton Chekhov, poets like John Keats, William Carlos Williams, Ma Jonggi, writers such as Somerset Maugham, Abraham Verghese, or even the Marxist revolutionary physician Che Guevara who made a substantial impact on Latin American politics during the Cuban revolution.

However, it is unusual to find a physician who made substantial contributions both in the fields of medicine they chose and also in areas of "art" in a larger context. Especially in surgical specialties, in comparison to other medical specialties such as psychiatry, internal medicine, family practice or pathology, etc., one could easily agree that surgeons overall are in a more difficult position to spend their extra hours focusing on non-medical issues. They must dedicate a certain number of hours of every day to the operating room, recovery area or intensive care unit, thus eliminating the flexibility of using available left-over hours.

However, in the history of surgery, we can find a few prominent surgeons who accomplished substantial achievements, both in the surgical field as well as other disparate fields such as music, literature, or religion, or as a social reformer.

With a deep sense of respect and admiration, the careers of those surgeons will be reviewed, including Christian Theodor Billroth, Sir Frederick Treves, Sir Geoffrey Langdon Keynes, Harvey Cushing, Leo Eloesser, Chang Kee-ryo (장기려), all of whom contributed substantially in a variety of fields

## **Gastro-Esophageal Reflux Disease, Barrett's Esophagus & Esophageal Cancers**

**Young Choi, M.D. (1966)**

Professor, Pathology and Lab Medicine, Yale School of Medicine, New Haven, CT

Since the 1970s, there has been a nearly 400% increase in the incidence of esophageal adenocarcinoma, an extremely lethal form of cancer with a five-year survival rate of 15% - 20%. The sequence of Reflux-Barrett's-Esophageal Cancer has been postulated in developing esophageal cancer (EAC).

Gastro-esophageal reflux disease (GERD) affects 18- 28% of the US population, and chronic injury of the gastro-esophageal junction by gastric or bile juice induces intestinal metaplasia of the squamous epithelium, Barrett's esophagus (BE) in 8%?15% of GERD. BE goes on to develop the premalignant condition with stepwise neoplastic changes through reactive, indefinite-low grade and a high grade dysplasia (cancer). Approximately 0.12%?0.38% of BE per year progresses to EAC. However, up to 40% of patients who had EAC report no history of GERD and less than 5% of patients who developed EAC have a previous diagnosis of BE. The majority of patients with BE remain undiagnosed, and/or patients with BE and dysplasia are often misdiagnosed. We often fail to refer these patients for early evaluation and intervention of this potentially preventable disease. When a patient is found to have BE on biopsy, the most important question is the degree of dysplasia; low-grade or high-grade dysplasia has a different management and surveillance program to prevent EAC.

Considering the stepwise progression of GERD-BE ?EAC through different stages, the demand for reliable biomarkers to predict Barrett's with or without dysplasia to EAC still remains indispensable. Studies have shown that genetic abnormalities of BE such as loss of genetic information (especially loss of 9p21, 5q, 13q, 17p, and 18q), gaining of genetic information (especially gain of 2p, 8q, and 20q), abnormality of c-erbB2 and cell adhesion molecules (E- and P-Cadherin and ?- and ?-Catenin), DNA abnormalities and epigenetic changes are associated with the progressive lesions to EAC. More importantly, the detection of aneuploidy, increased tetraploidy and loss of heterozygosity (LOH) for chromosome 17p in patients with no dysplasia or low grade dysplasia on biopsy has been shown to have good predictive value for neoplastic progression.

Therefore, the diagnosis of BE and also BE with the earliest neoplastic changes should be based on the combination of careful endoscopic evaluation and histology review of the biopsy, and molecular and protein biomarker testing. The probability to find one single specific biomarker providing all diagnostic, predictive, and prognostic significance in GERD, BE, and/or EAC is not effective. Our study shows that a panel of biomarker testing is needed in the diagnosis and surveillance of these patients.



## **Pathogenesis and Therapy for Alzheimer's disease & Parkinson's disease and Introduction of Korea Brain Research Institute (KBRI)**

**Yoo-Hun Suh, M.D., Ph.D. (1973)**

President, Korea Brain Research Institute (KBRI)

Professor Emeritus, Seoul National University College of Medicine, Seoul, Korea

Several lines of evidence suggest that some neurotoxicity in Alzheimer's disease (AD) is caused by proteolytic fragments of amyloid precursor protein (APP), which generates amyloid beta (A $\beta$ ) by proteolysis. However, amyloid beta (A $\beta$ ) may not be the sole active component involved in the pathogenesis of AD. The CTFs, Carboxy-terminal fragments of APP, including AICD (Amyloid Intra Cellular Domain) have been found in AD patients' brain. We proposed the hypothesis that CTFs might importantly contribute to pathogenesis of AD by different mechanisms from A $\beta$ .

To investigate the regulatory genes responsible for the neuropathology in AD, we performed microarray analysis in APPV717I-CT100 transgenic mice and isolated the S100a9 gene. We also found that S100a9 expression was increased in the brains of Tg2576 mice, animal model of AD and AD patients. Silencing S100a9 gene decreased the production of inflammatory cytokines induced by A $\beta$  or APP-CTs. In Tg2576 mice, knockdown and knockout of S100a9 gene significantly reduced the neuropathology and improved the learning ability. These results clearly show that the upregulation of S100a9 gene plays an important role in the neuropathology and memory impairment in AD, suggesting that the regulation of this gene has a therapeutic potential for AD.

We examined whether intracerebrally or intravenously transplanted human adipose-derived stem cells (hASCs) could have therapeutic or preventive effects in AD mouse model (Tg2576). We demonstrated that intracerebral or intravenous injection of hASCs rescued memory deficit and gave benefits of blocking the pathogenesis in the brain of Tg mice by reducing the number of plaques and neuropathology. Hence, we demonstrated that hASCs are expected to be preventive and therapeutic for AD, and IV hASC therapy might be revolutionary in future.

PD is caused by the progressive degeneration of dopaminergic neurons and is characterized by cytoplasmic inclusions known as lewy bodies in the substantia nigra. In many studies, it has been described that the structural and functional alteration of mitochondria were associated with neurodegenerative diseases including PD. Therefore, we investigated the effects of intra-venous injection of hASCs on mitochondrial functions in PD mouse model. Intravenous injection of hASCs greatly improved behavior and mitochondrial dysfunction in PD mice model.

Lastly I will briefly introduce Korea Brain Research Institute(KBRI).

## **Biomarkers for Diagnosis and Treatment of Lung Cancers: Update in 2015**

**(Joanne) Eunhee Suh Yi, M.D. (1982)**  
Professor and Consultant of Pathology,  
Mayo Clinic College of Medicine, Rochester, MN

Lung cancer is the leading cause of cancer death worldwide for both men and women. Small cell lung carcinoma (SCLC) and nonsmall cell lung carcinoma (NSCLC) comprise the two major types of lung cancers with distinct morphologic findings and clinical behaviors that require different therapeutic approaches. NSCLC is further divided into the 3 main types: adenocarcinoma, squamous cell carcinoma and large cell carcinoma. NSCLC comprises 75% to 80% of all lung cancers, and currently available conventional chemotherapeutic regimens have done relatively little to improve outcome in NSCLC patients over the past decades. However, recent advances in targeted therapies against the oncogenic driver mutations have improved outcomes in lung cancer patients, particularly who have adenocarcinomas with appropriate molecular targets in their tumors. For selecting the patients for an appropriate targeted therapy, specific biomarkers have been tested in routine clinical practice using immunohistochemical and/or various molecular methods. Currently, there are two classes of FDA approved targeted therapies for NSCLC with companion diagnostic biomarker testing: ALK inhibitor (crizotinib) and EGFR inhibitor (gefitinib and erlotinib).

Despite these advances in targeted therapy, most patients who responded initially will eventually develop resistance and overall survival of patients with NSCLC still remains dismal. Also, these targeted therapies are mostly for adenocarcinomas occurring in nonsmokers, but not for squamous cell carcinomas or small cell carcinomas that primarily affect smokers. Recently, it has been noted that interactions of cancer cells with the host immune system are as important as the properties of cancer cells per se in tumorigenesis. Smoking- and pollution-associated lung cancers possess a high density of missense mutations in expressed genes. These genetic alterations, together with other changes via epigenetic dysregulation, provide lung cancer cells with many tumor specific neoantigens recognizable by host T cells. Tumors can evade immune destruction via immune checkpoint signals that suppress the host immune responses to tumor cells. A better understanding of tumor immunosurveillance led to the development of a new generation of immunotherapeutic agents that restore the host immune response to tumor cell antigens. Several immunotherapeutic agents have been tested in clinical trials. Results from early phase studies of these immune checkpoint modulators are highly promising in NSCLCs. This new approach may prove to be effective especially in the treatment of squamous cell carcinomas, for which there is no currently available FDA-approved targeted therapy. It is very likely that small cell carcinoma patients might be benefited from immunotherapy as well.

The current status of available biomarker testing in the area of targeted therapy and immunotherapy will be covered based on literature review and Mayo experience, which would provide an overview and update on this rapidly progressing field of lung cancer diagnosis and treatment.

## **Pharmacological Modeling of GABA Deficit in Schizophrenia.**

**Kyung-Heup Ahn, M.D. (96), Mohini Ranganathan, M.D., John Krystal, M.D., Deepak Cyril D'Souza, M.D.**  
Assistant Professor, Department of Psychiatry, Yale School of Medicine, CT

Converging lines of evidence, including postmortem, genetic, and brain imaging studies suggest that the dysfunction of the GABA system contributes to the pathophysiology of schizophrenia. Despite, in clinical practice, GABAergic medications, including benzodiazepine, has limited role in the management of psychosis, due to the lack of antipsychotic effects.

Developing concept that GABA deficit can create vulnerability to psychosis may explain such disparity. Based on this vulnerability model, GABA deficit was modeled using iomazenil, an antagonist and partial inverse agonist of benzodiazepine receptor. It has been shown that iomazenil can worsen psychosis in schizophrenia and also can create higher vulnerability to psychotomimetic agents with different pharmacological profiles.

In this presentation, evidenced of GABA deficit and the use of iomazenil as a pharmacological model of GABA deficit in schizophrenia will be reviewed.

**Kyung Heup Ahn (96) Psychiatry**  
Yale School of Medicine  
Department of Psychiatry

Dr. Kyung Heup Ahn completed his psychiatry residency at Yale in 2008 and obtained fellowship training in psychopharmacology at Yale. He was awarded a National Alliance for Research on Schizophrenia and Depression (NARSAD) young investigator award in 2009 for his work in psychopharmacology. He was appointed as a faculty at Yale in 2010. His primary research interest is GABAergic deficit in schizophrenia. His wife, Gye Yee Shin (97) is also a SNUMC graduate, who completed her residency in the US in 2009 and is currently working as a family physician in a private clinic in Fairfield county, Connecticut.

## Osteoporosis in Geriatric Patients

**Junghoon Kim, M.D. (1999)**

Assistant Professor, Geriatrics, Department of Medicine,  
Baylor College of Medicine, Dallas, TX

Osteoporosis is a skeletal disorder characterized by compromised bone strength, predisposing to an increased risk of fracture. About 40-50% of women and 20% of men older than age 50 suffer an osteoporosis-related fracture within their lifetime. Fewer than half of hospitalized hip fracture patients recover pre-fracture level of functionality. Mortality after hip fracture is as high as 31% in elderly women.

Under-treatment and missing-treatment after acute fracture are very common. The optimal duration of oral/intravenous bisphosphonates is still controversial. Given that bisphosphonate treatment can precipitate complications such as atypical fracture of femur and osteonecrosis of jaw bone, the duration of the treatment is recommended to be limited to three to five years.

Recommended frequency of bone density screening is determined by the initial bone mineral density test results. Normal or mild osteopenia patients do not need frequent screening and the subsequent test can be 5 years later. However, advanced osteopenia and the older age group patients need a shorter interval.

A geriatric population is heterogeneous. Guidelines for osteoporosis can be safely applied to a robust, age-defying group. However, there is few data available on the treatment efficacy in special populations such as debilitated elderly group or non-ambulatory, nursing home populations. Also specific considerations are warranted when active medications are prescribed. Medication interaction, tolerance, compliance and cost should be carefully considered.

**Jung-hoon Kim (99) Geriatrics**  
Baylor College of Medicine  
Department of Medicine, Section of Geriatrics



After completing his internal medicine residency at Albert Einstein Medical Center in Philadelphia, PA in 2007, Dr. Jung-hoon Kim obtained fellowship in Geriatric Medicine at the University of Pennsylvania. He then stayed on at Penn for 3 years as faculty, during which time he earned his Master's Degree in Translational Research. In 2012, Jung-hoon and his wife moved to Houston, TX, where he joined the faculty at Baylor College of Medicine. His wife Hyunseon Kang (98), also an alumna of SNUCM, is a diagnostic radiologist at the University of Texas MD Anderson Cancer Center. Dr. Kim has special interest in dementia and aging-related bone diseases. He has a diverse clinical practice including the outpatient geriatric clinic, the osteoporosis clinic and the inpatient geriatric consult service at Baylor-St. Luke's hospital.